

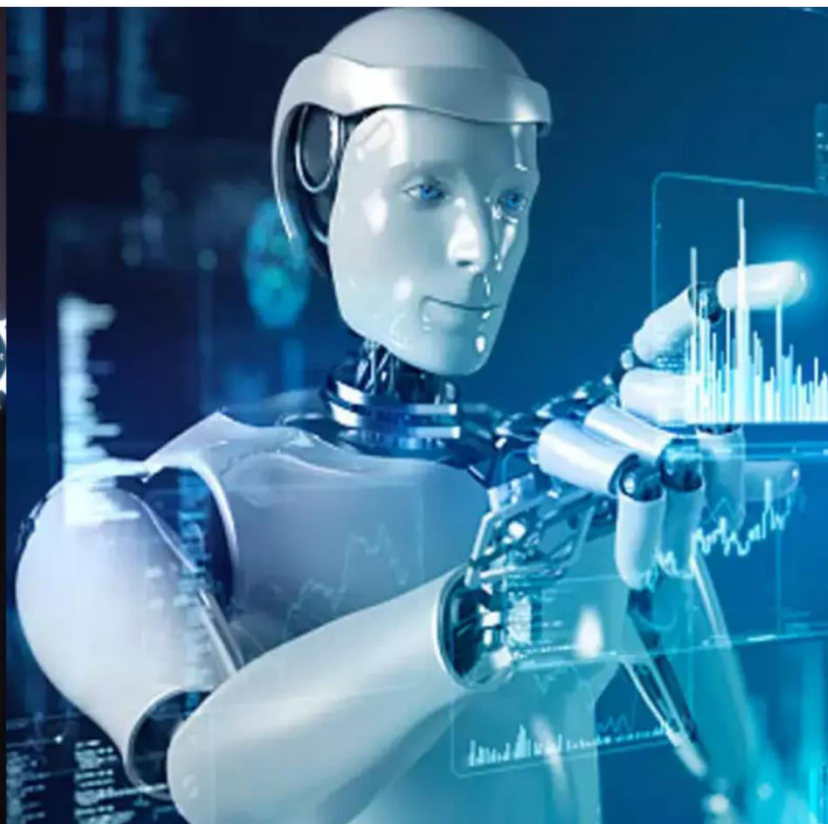

International Journal of Innovative Research in Science Engineering and Technology (IJIRSET)

(A Monthly, Peer Reviewed, Refereed, Scholarly Indexed, Open Access Journal)



Impact Factor: 8.699

Volume 15, Issue 1, January 2026

Performance Evaluation of Infilled Reinforced Concrete Frame Structures via Computational Analysis

Sagar Rajendra Gaikwad¹, Dr.V.A.Patil²

P.G. Student, B.R.Harne College of Engineering & Technology, Karav, Thane, India¹

Principal and Guide, B.R.Harne College of Engineering & Technology, Karav, Thane, India²

ABSTRACT: It has always been a human aspiration to create taller and taller structures. The reinforced cement concrete moment resisting frames in filled with unreinforced brick masonry walls are very common in India and in other developing countries. Masonry is a commonly used construction material in the world for reason that includes accessibility, functionality, and cost. Normally considered as architectural elements. Engineers often neglect their presence. Because of complexity of the problem, their interaction with the bounding frame is often neglected in the analysis of building structures. When masonry infills are considered to interact with their surrounding frames, the lateral load capacity of the structure largely increases.

The survey of buildings damaged in earthquakes further reinforces this understanding. The positive aspects of the presence of infills are higher strength and higher stiffness of the in filled frames. In high rise buildings, the ordinarily occurring vertical loads, dead or alive, do not pose much of a problem, but the lateral loads due to wind or earthquake tremors are a matter of great concern and need special consideration in the design of buildings. These lateral forces can produce the critical stress in a structure, set up undesirable vibrations and in addition, cause lateral sway of the structure which can reach a stage of discomfort to the occupants.

I. INTRODUCTION

Analytical and experimental studies on the seismic response of the infill frame began in the mid- 1950s. Several studies have shown that the filling significantly improves the lateral strength and stiffness of the bare square and greatly improves the dissipation capacity of energy of the structure.

The guidelines on building Safety have been developed with the vision that all high- r i s e buildings in India will be structurally and functionally safe from disasters, such that the risks to human life and infrastructure are minimized. The RCC building is analyzed by using STAAD.Pro. In this analysis the comparison of storey drift, storey displacement, base shear, column and beam forces are calculated by using STAAD.Pro of RCC building for bare and infill frame. An earthquake is the vibration of the earth's surface that follows a sudden release of energy in the crust. During an earthquake, the ground surface moves in all directions. The most damaging effects on buildings are caused by lateral movements which disturb the stability of the structure, causing it to topple or to collapse sideways. Since buildings are normally constructed to resist gravity, many traditional systems of construction are not inherently resistant to horizontal forces. Thus, design for earthquakes consists largely of solving the problem of building vibrations. The design of buildings is fundamentally concerned with ensuring that the components of buildings, e.g. lateral force-resisting system, can adequately serve their intended functions. In the case of seismic design of the lateral force-resisting system, the design problem can be reduced simply to the problem of providing adequate force and deformation capacity to resist the seismic demands.

The studied building in this paper is a typical 10-storey model of commercial building. The building is comprised of a reinforced concrete structural frame. The overall plan dimension is 22.5m × 22.5 m with 49.1 m in height as shown in fig: 1.1

Earthquake resistant design structures are those, which are able to dissipate seismic forces generated due to strong ground motions. In current seismic codes, there are several designs.

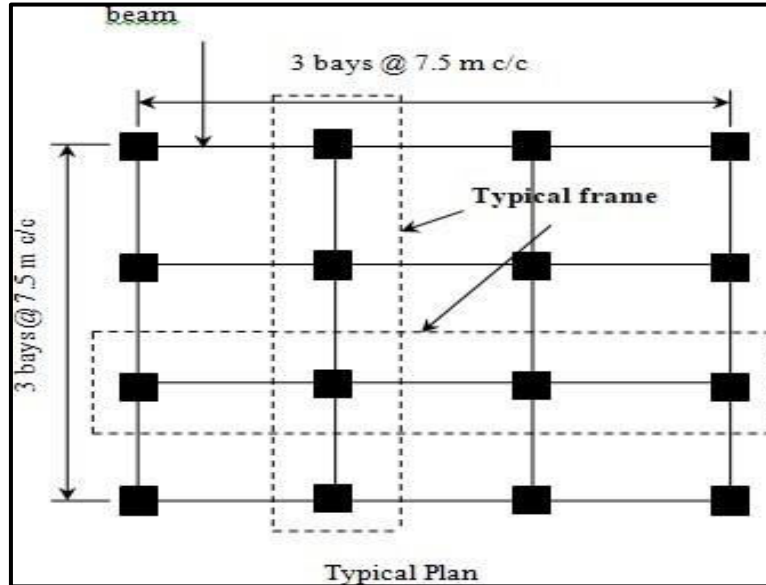

Fig no: 01 Typical Plan of the commercial building

II. LITERATURE REVIEW

Summary

1. Infill Panel can be considered equivalent to diagonal bracing and modelling as diagonal compression strut.
2. The Analysis shows an increase in the initial stiffness, Strength and energy dissipation of the filled Frame.
3. It is identified that due to the filling walls in the high-rise building, the displacement of the upper floor is reduced
4. The influence of masonry infill on the seismic performance of a ductile RC structure and the results provided are consistent with experimental evidence and dynamic non-linear analyzes.
5. Due to the increase in stiffness provided by the filling, the achievement of the different limit states in terms of deviation was anticipated in the case of the inflated structure with respect to the bare counterpart.
6. The dynamic seismic behavior of the two types of fill material, such as blocks and ALC bricks, was studied. The performance of the ALC filling was greater than that of the conventional brick lining in the RC frame. Therefore, the material of the ALC block can be used to replace conventional bricks as a filler material for RC frames built in the earthquake-prone region

Objective and Scope of work:-

Objectives: -

1. To understand the performance of RCC frame structure by bare frame and infill RC frame
2. To find out the changes in the value of various structural parameters like time period, storey shear, Nodal displacement and acceleration using response spectrum analysis.
3. In this exploration, the goods of masonry infill on the stability of the structure in seismic region are delved.
4. The response of the structure in the time history analysis and the response diapason analysis is studied.

Scope of Work:-

1. Detailed analytical study on performance assessment by using staadpro V8i software
2. The study is limited to G+10 storey of RCC building.
3. Two different commercial building with G+10 storey is designed.
4. In filled RC frame is provided on various places

III. METHODOLOGY

Step for design and analysis: -

1. Modelling of structure in Staadpro for understanding the performance of RCC frame structure with infill RC frame.
2. Study the performance of RCC frame structure by bare frame compare to the Infill RC frame
3. Analysis of structure applying data over increment time step as a function of acceleration force, moment and displacement
4. Again Response spectrum analysis is carried for static lateral load analysis of structure for evaluating the safety and reliability of structure under earthquake forces.

Problem Statement:-

The Present work involves the study of structure with and without infill RC frame. A typical plan of commercial building is created in staadpro software with G+12 storey (55.8m height).The main aim of the study is to find out the difference in various parameter of structure by using staadpro software by performing Response spectrum analysis.

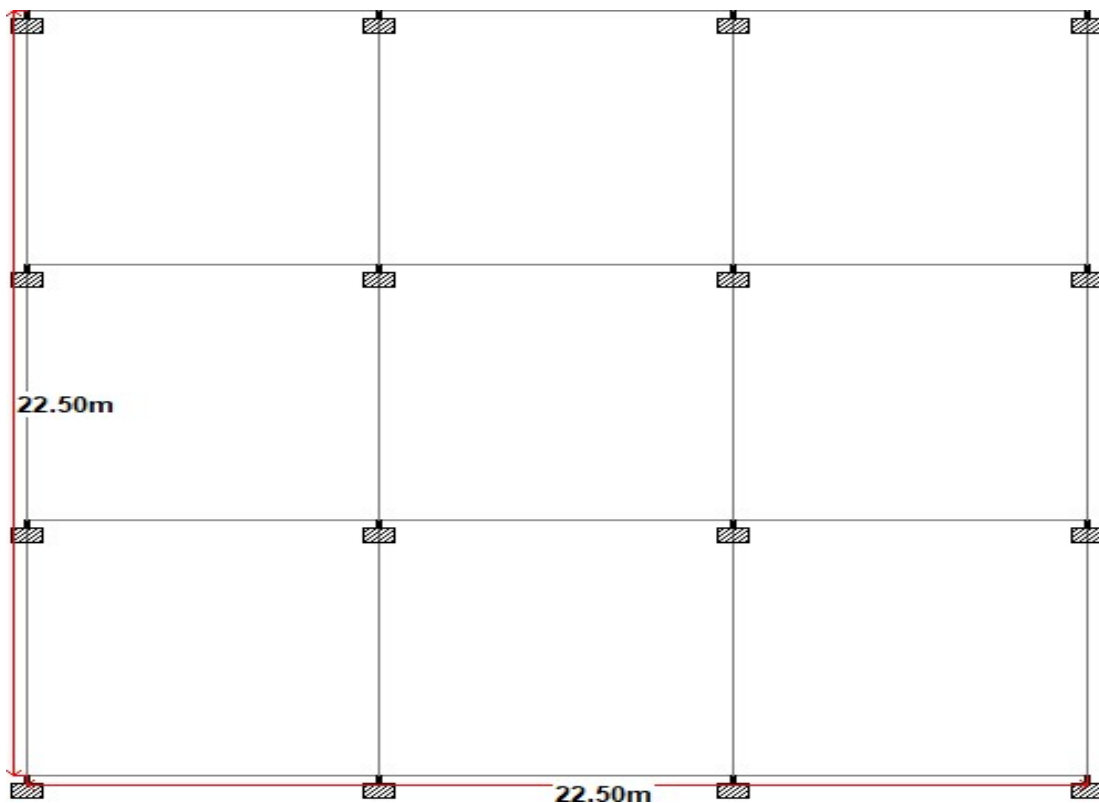
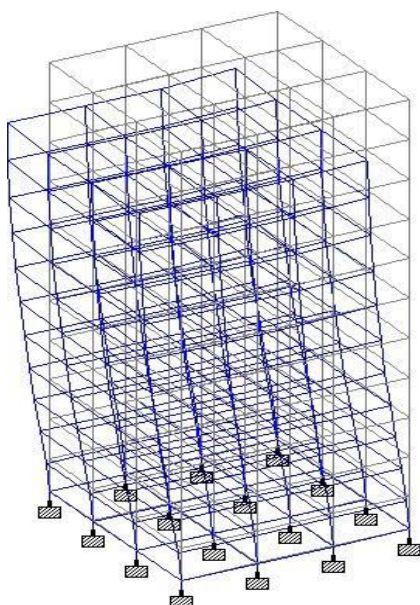

Fig: 02 typical plan of the commercialbuilding

IV. RESULTS

Table 01-frequency and time period of mode shape for bare frame

Mode	Frequency (cycles/sec)	Period (sec)
1	0.272	3.67266
2	0.272	3.67266
3	0.318	3.14331
4	0.789	1.26748
5	0.817	1.22451
6	0.817	1.22451



Mode Shape 1- Corresponding to the frequency 0.272 and period 3.67266

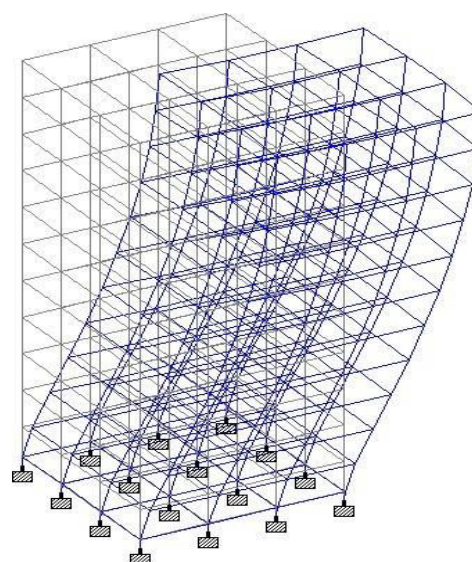

Mode shape 2 corresponding to the frequency 0.272 and period 3.67266

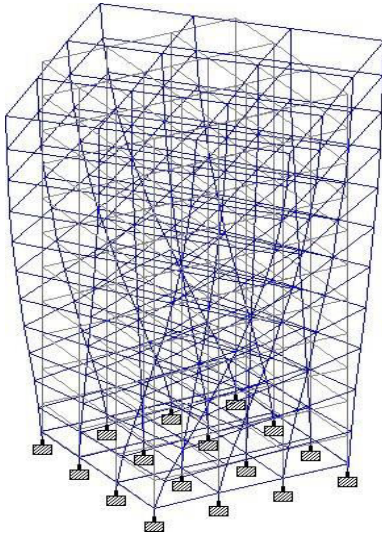

Mode shape 3 corresponding to the frequency 0.318 and period 3.14331

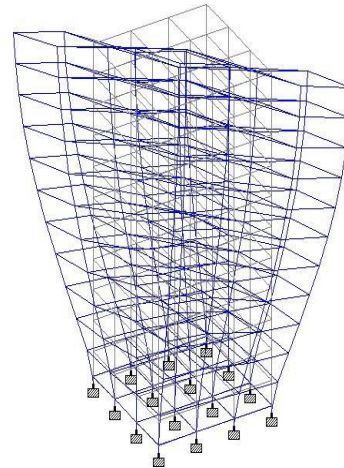

Mode shape 4 corresponding to the frequency 0.789 and period 1.26748

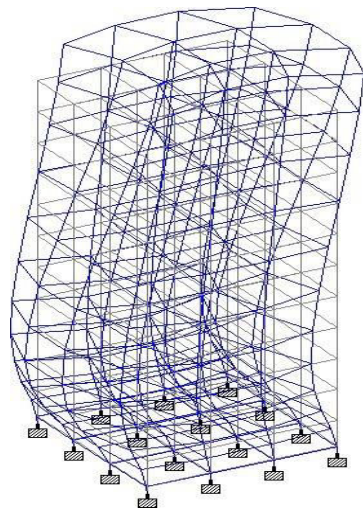

Mode shape 5 corresponding to the frequency 0.817 and period 1.22451

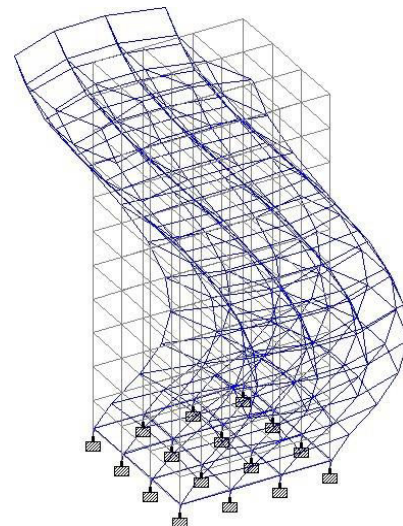

Mode shape 6 corresponding to the frequency 0.817 and period 1.22451

Table 02 -frequency and time for mode shape period infill fram

Mode	Frequency(cycles/sec)	Period(sec)
1	0.956	1.04575
2	0.967	1.03465
3	1.825	0.54786
4	2.531	0.39510
5	3.149	0.31757
6	3.414	0.29292

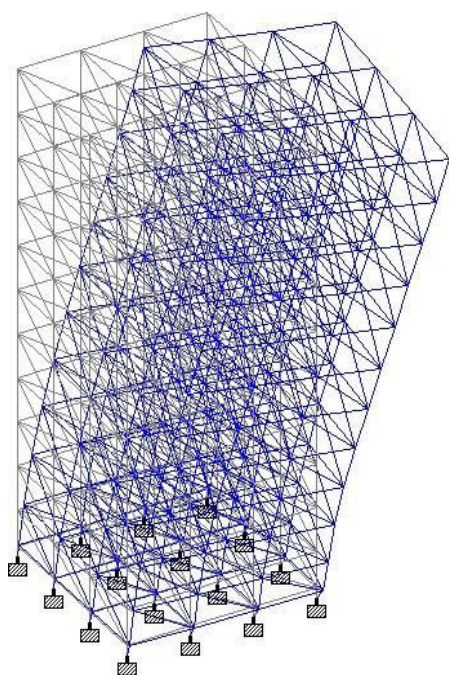

Mode Shape 1 corresponding to the frequency
0.956and period 1.04575

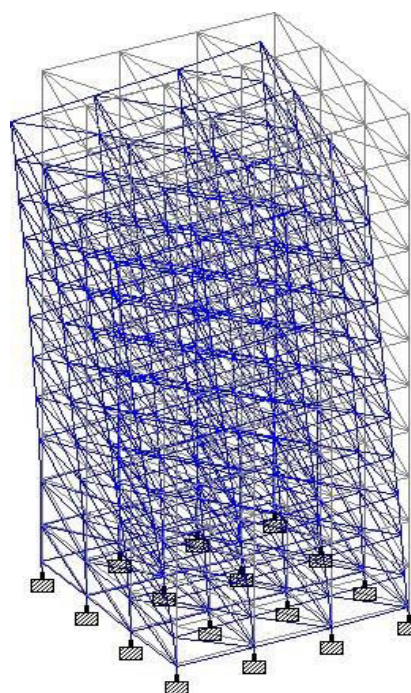

Mode Shape 2 corresponding to the frequency
0.967and period 1.03465

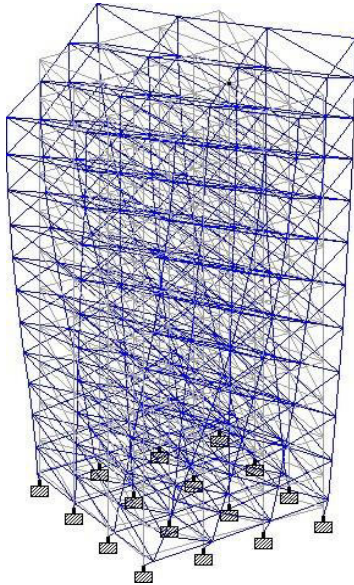

Mode Shape 3 corresponding to the frequency 1.825 and period 0.54786

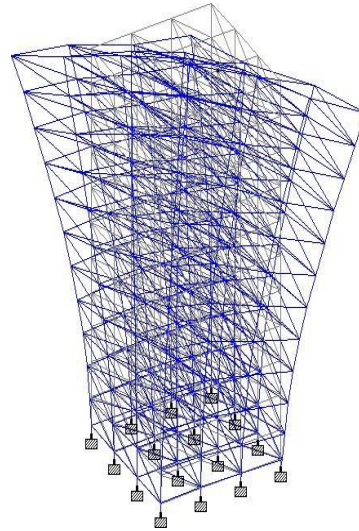

Mode Shape 4 corresponding to the frequency 2.531 and period 0.39510

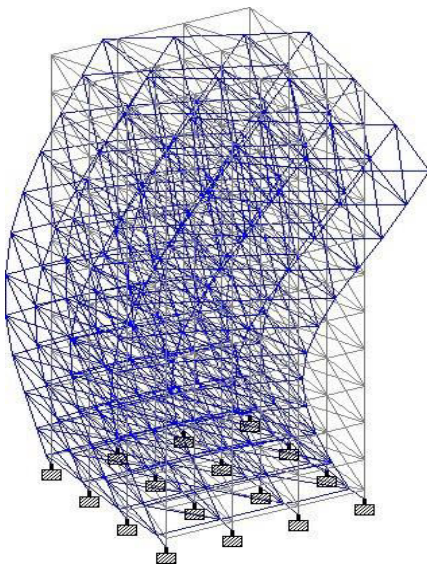

Mode Shape 5 corresponding to the frequency 3.149 and period 0.31757

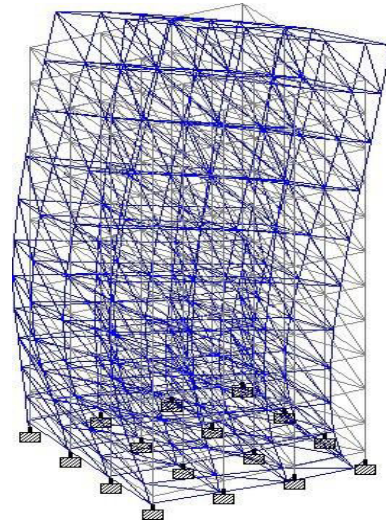

Mode Shape 6 corresponding to the frequency 3.414 and period 0.29292

Table no: 03- storey shear of bare frame and infill frame

Storey	level in meter	Peak story shear in KN including shear from torsion	
		bare frame	infill frame
12	55.3	72.35	375.93
11	50.3	162.19	810.24
10	45.3	235.84	1126.75
9	40.3	290.48	1348.39
8	35.3	329.15	1514.83
7	30.3	359.71	1671.4
6	25.3	390.56	1849.13
5	20.3	424.99	2049.75
4	15.3	458.4	2249.06
3	10.3s	484.4	2414.31
2	5.3	494.88	2521.17
1	1.2	495.57	2567.48
Base shear	0.00	495.57	2567.48

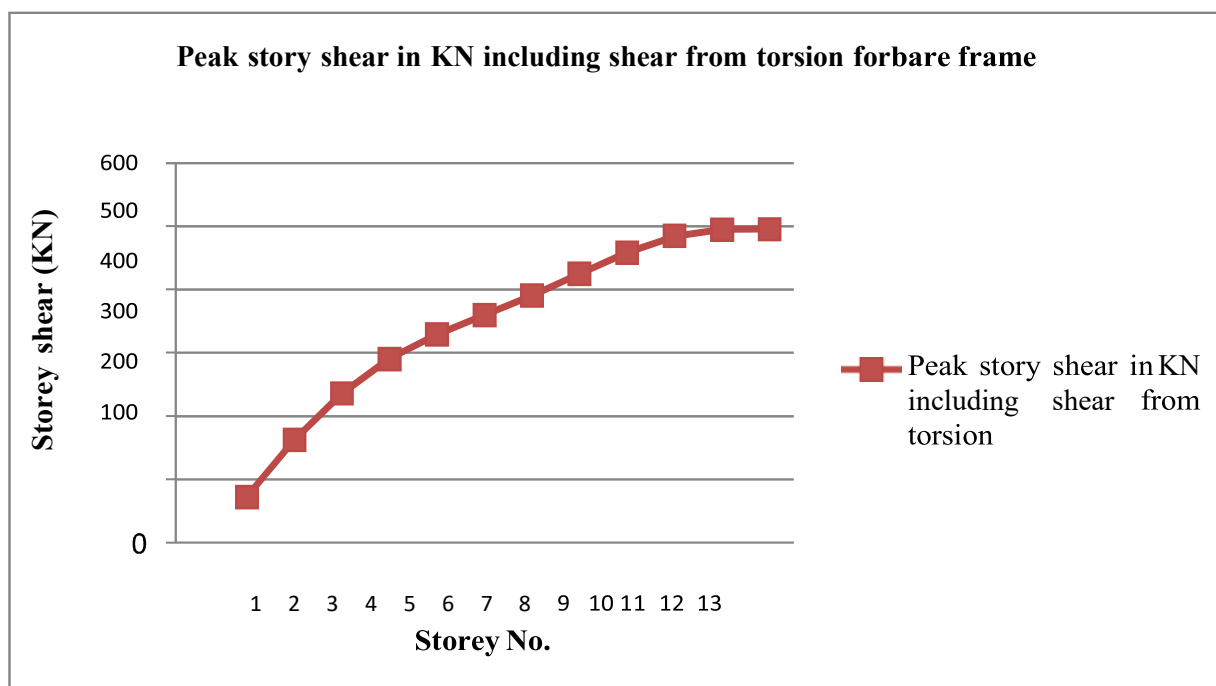

Fig: 03-Storey shear of bare frame with respect to storey

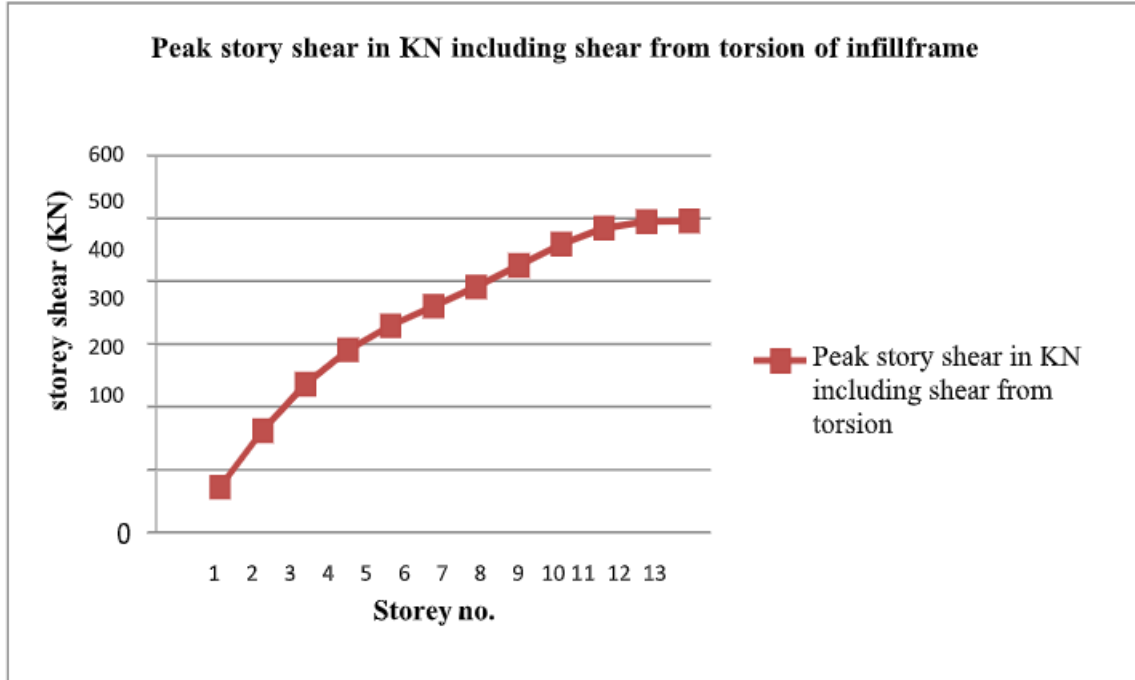

Fig: 04- storey shear of the infill frame with respect to storey

V. CONCLUSION

- 1) In this exploration, the goods of masonry infill on the stability of the structure in seismic region are delved.
- 2) The response of the structure in the time history analysis and the response diapason analysis is studied.
- 3) It's observed that the structure with completely masonry infill is stiffer than the bare structure.
- 4) The outside in deviation in bare frame for(g 10) is47.05 mm and by strut frame it's minimal which36.04 mm. If the effect of infill wall is considered also the deviation has reduced drastically.
- 5) From this present result it shows that, deviation is veritabaly large in case of bare frame as compare to that of infill frame with opening. If the effect of infill wall is considered also the deviation has reduced drastically. And also, deviation is more at last storey because earthquake force acting on it more effectively.
- 6) In the response diapason analysis, the base shear for the bare frame and for infill frame is set up out.
- 7) The base shear for the bare frame is 495.57 KN and for the infill fame is2567.48 kN from the response diapason analysis affect it shows that, the base shear for the infill frame is further than the bare frame, hence structure with masonry infill is stiffer than the bare structure.

REFERENCES

1. Siamak Sattar And Abbie B. Liel (2010) , “Seismic Performance of Reinforced Concrete Frame Structures with And Without Masonry Infill Walls.”
2. Wakchaure M.R, Ped S. P (2012) ,Earthquake Analysis of High-Rise Building with and Without In filled Walls , International Journal of Engineering and Innovative Technology (IJEIT) Volume 2, Issue 2, August 2012
3. M. S. Razzaghi And M. Javid Nia (2015) , “Evaluation of The Effect of Infill Walls on Seismic Performance of RC Dual Frames”
4. Luis Decanini, Fabrizio Mollaioli, Andrea Mura, Rodolfo Saragoni (2004) , “Seismic Performance Of Masonry Infilled R/C Frames” , 13th World Conference on Earthquake Engineering Vancouver, B.C., Canada August 1-6, 2004 Paper No. 165
5. Marco Valente (2012) , “Seismic Performance Assessment of a Masonry Infilled Ductile RC Structure” IACSIT International Journal of Engineering and Technology, Vol. 4, No. 6,
6. December 2012

7. K. Thinley & H. Hao ,(2015) , “Seismic Assessment of Masonry Infilled Reinforced Concrete Frame Buildings in Bhutan”, Proceedings of the Tenth Pacific Conference on Earthquake Engineering Building an Earthquake-Resilient Pacific 6-8 November 2015, Sydney, Australia .
8. Khubaib Ilyas Khan M.1 And Saim Raza ,(2015), “Seismic Performance Assessment of Masonry Infilled Reinforced Concrete (RC) Frame Structures ” ,International journal of civil and structural engineering Volume 6, No 1, 2015 ,ISSN 0976 – 4399
9. Momin Mohmedakil M And P.G.Patel , (2012), “Seismic Assessment of RC Frame Masonry Infill With ALC Block” , International Journal of Advanced Engineering Research and Studies , E-ISSN2249–8974
10. M.R.Suresh , (2016) " Seismic Performance Study of RC Bare Ane Infill Frame with Soft Story at Different Floors by Non-Linear Static Method” , IRJET volume 3 .
11. Monika N¹, Chaitra D M², Kirankumar K L³ , “Comparative Study of Seismic Behavior of RCC Building Frames with and Without Masonry Infill Wall” , IRJET,Volume: 04 Issue: 05 | May -2017
12. Nasratullah Zahir¹, Dr. Vivek Garg² , “Static and Dynamic Analysis Of R.C Building Frame with Infill” , IRJET , Volume: 04 Issue: 07 | July -2017
13. Nikunj Mangukiya ²Arpit Ravani ³Yash Miyani ⁴Mehul Bhavsar , “Seismic Behaviour of R.C Frame Building with and Without Masonry Infill Walls” Global Research and Development Journal for Engineering , March 2016
14. IS1893:2002 -“Criteria for Earthquake Resistant Design of Structure.”
15. IS4326:1993 – “Earthquake Resistance Design and Construction of Building”
16. “Earthquake resistance design of structure” , Pankaj Agarwal And Manish Shrikhande
17. www.civildigital.com
18. www.google.com
19. www.quora.com



INTERNATIONAL
STANDARD
SERIAL
NUMBER
INDIA



INTERNATIONAL JOURNAL OF INNOVATIVE RESEARCH

IN SCIENCE | ENGINEERING | TECHNOLOGY

 9940 572 462  6381 907 438  ijirset@gmail.com



www.ijirset.com

Scan to save the contact details